



Optional-EKA pump with water-proof cover

Features

- 1.All-in-one booster pump unit, The EKA pump is mainly consisted of pump, motor, flow sensor, and CPU board.
- 2.All-in-one booster pump unit, The EKA pump is mainly consisted of pump, motor, flow sensor, and CPU board.
- 3.Auto run and boost water pressure while water is consumed. Auto stop running while no water is consumed.
- 4.Dry-running shutdown protection- To avoid motor coil burnout, EKA pump will shut down within 30 seconds when dry running occurs.
- 5.Built-in thermal protector can prevent pipeline burst due to abnormal frequent on/off.
- 6.Low noise operation; More Compact design for space saving.
- 7.Always keep stable water pressure while using (hot) shower.

Model	Power	Activation Pressure
EKA200	1/4HP	1.4 bar
EKA400	1/2HP	1.7 bar
EKA800	1 HP	2.0 bar

- Pre-set activation pressure is adjustable by professionalist

Operating Conditions

- 1.Ambient Temp.: Max.40°C.
- 2.Liquid Temp.: 0~40°C.
- 3.Relative humidity: Max.85%(RH).
- 4.Working pressure: Max. 5 bar.
- 5.Before starting the pump, make sure inlet pressure is lower than factory pre-set activation pressure.
- 6.Suitable liquid: Drinking water or clean water without solid particles or non-corrosive fluid.

Applications

- 1.Auto boost water pressure to the house, apartment, villa, school, restaurant, school, beauty shop,...etc.
- 2.Auto boost water pressure to garden sprinkler, heater, toilet, washing machine, sanitary equipment,...etc.

Motor Spec.

- 1.Voltage: 1Ø110/220V*60Hz.
2. Enclosed class: IP54.
3. Insulation: B class.
4. Enclosed Fan cooled, 2P motor.
5. Built in overload motor protector.

Installation of EKA Pump

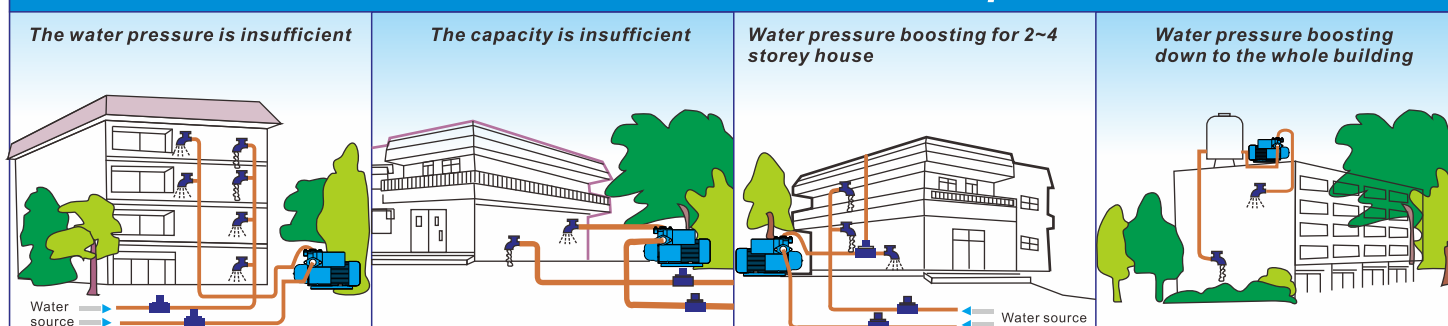

Sectional View & Materials

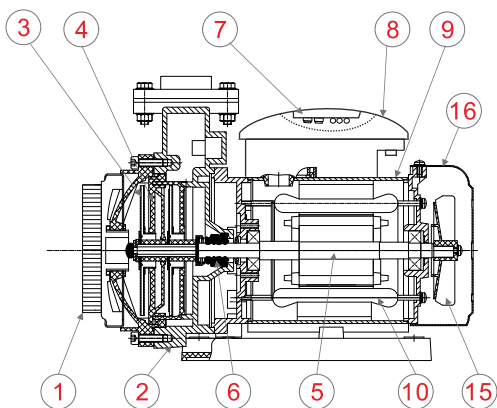

NO.	Name	Material	NO.	Name	Material
1	Front cover	PPO	9	Motor Shell	Aluminum Alloy
2	Pump casing	FC200	10	Motor Coil	Copper
3	Impeller	SUS304	11	Base	ABS
4	Guide Vane	PPO	12	Flanges	SS400(SS41)
5	Shaft	SUS420	13	Flow sensor	
6	Mechanical Seal	CA/CE	14	Check valve	NYLON66
7	CPU board		15	Motor fan	ABS
8	Terminal Box	ABS	16	Back cover	ABS

Performance Curves

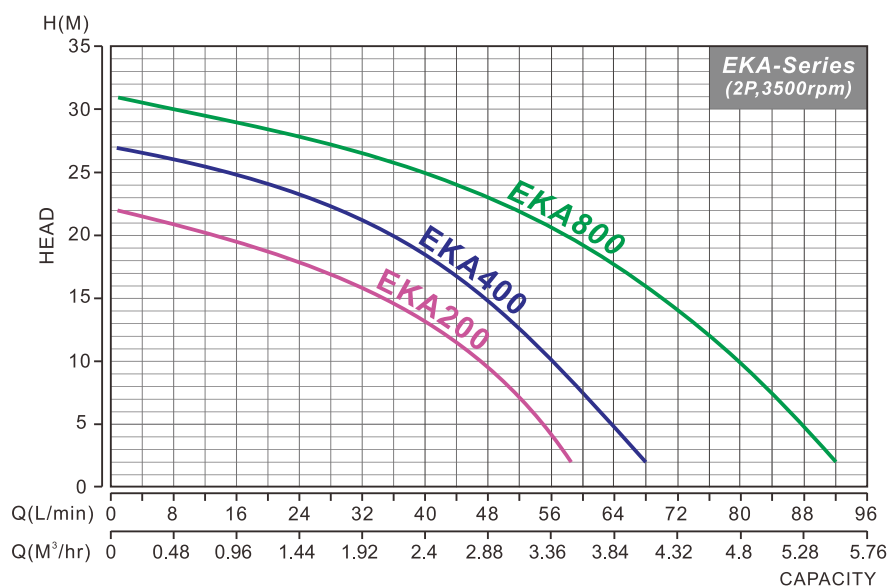
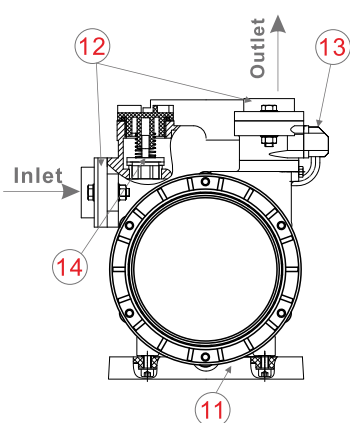

Specifications

Model	Power		Inlet/Outlet		Pole	Phase	Voltage	Pressure		Rated Head	Rated Flow	Max. Head	Max. Flow
	W	HP	Inch	mm				On (Kg/cm ²)	Off (Kg/cm ²)			M	L/min
EKA200	180	1/4	3/4"	20	2	1	110/220	1.4	2.2	15	35	22	60
EKA400	370	1/2	1"	25	2	1	110/220	1.7	2.7	20	36	27	70
EKA800	750	1	1"	25	2	1	110/220	2.0	3.1	25	40	31	95

Suction Lift: Max. 4M

Dimensions

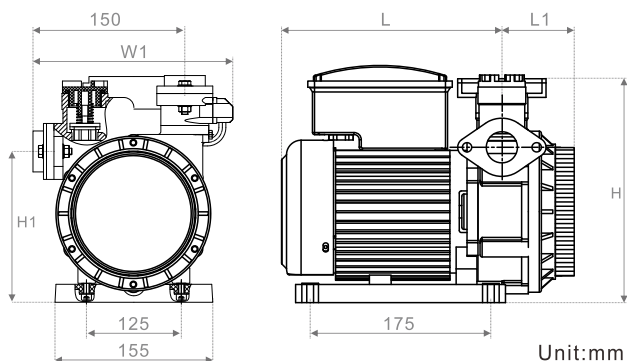

Model	Dimensions (mm)					Net Weight (KG)
	L	L1	W1	H	H1	
EKA200	215	95	210	235	150	10.7
EKA400	235	95	210	235	150	12.2
EKA800	260	95	210	235	150	14.0