

XA bare shaft pump



XA pump with IEC standard motor



Optional-XA pump with inverter(VFD) motor

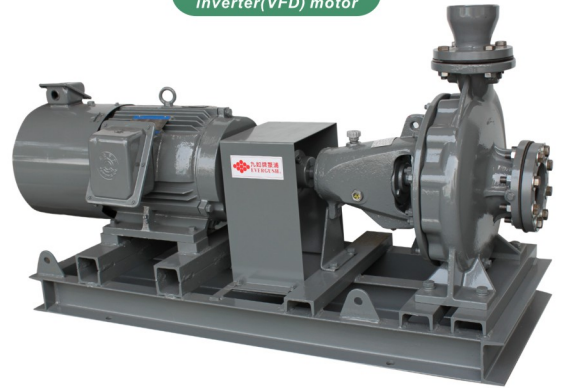

## Features

1. Back-pull-out design for easy removal of bearing housing assembly and the volute casing for repair without having to disturb the connected pipeline. This advantage enables fast and easy dismantling for servicing, resulting in lower maintenance costs.
2. Single stage end suction centrifugal pump with foot mounted, is designed to comply with international standard EN733 which substitutes for DIN24255.
3. Quality bearing- each shaft module consists of two identical bearings, grease or oil lubricated, lifetime design for more reliability and less maintenance.
4. It requires only 5 kinds of bearing housings, 6 kinds of shafts and 4 kinds of bearings to make the assembly of the entire 42 models. It will effectively minimize accessory inventory and enhance pump components interchangeability.
5. To suit the demand for the variety of applications, XA model provides Grey Cast Iron as standard and various optional materials construction upon aggressive and abrasive medium.
6. Shaft sealing with mechanical seal as standard for protecting against environment damage due to leakage. Gland packing is also available upon request.

## Applications

1. Heating and cooling water circulation.
2. Broad range of industrial applications.
3. Open loop and close loop water circuit systems.
4. Water supply and pressure boosting systems.
6. Process water for paper mill, brewery, refinery.
7. Boiler feed, washing and cleaning system.
8. General purpose water transfer and drainage.
9. Water supply for fire-fighting systems.
10. Irrigation and Agriculture.

## Components Illustration

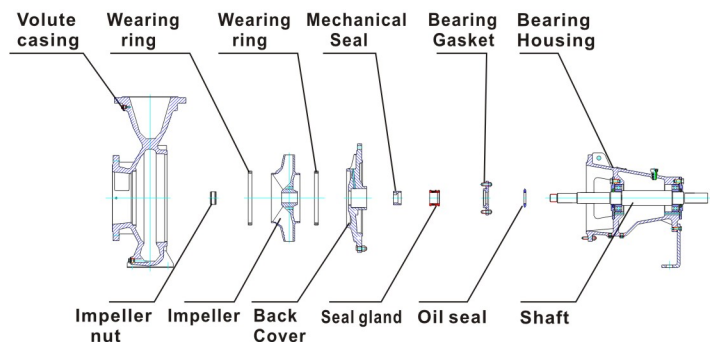

## Sectional View

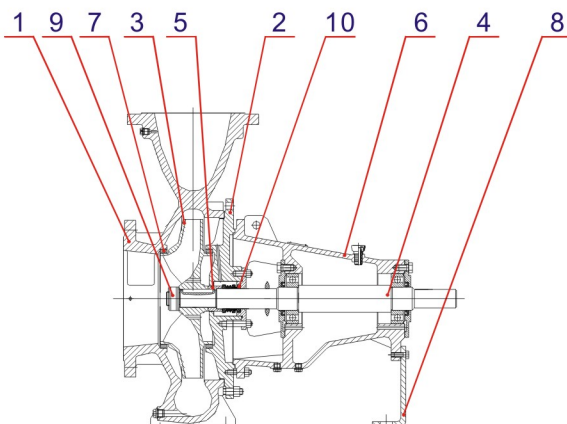

N0	Part Name	Standard material	Substitute material
1	Volute casing	FC250	SUS304
2	Back cover	FC250	SUS304
3	Impeller	FC250 or Bronze	SUS304
4	Shaft	SUS420	SUS304
5	Shaft sleeve	Bronze	SUS304
6	Bearing housing	FC250	----
7	O-ring	NBR	Teflon
8	Support foot	SS400	----
9	Impeller nut	SUS304	----
10	Mechanical seal	CA/CE	SIC/SIC

• Ductile cast iron is available for pump material selection.

### Operating Conditions

1. For clean non-corrosive or non-aggressive liquids, without solid particles or abrasives.
2. Capacity: Max. 1000m<sup>3</sup>/hr.
3. Total head: up to 110m.
4. Discharge flanges: 32mm to 250mm.
5. Suction flanges: 50mm to 300mm.
5. Working pressure: 10 bar in standard.
6. Liquid temperature: 0~+100°C.

### Model Code

**XA6520**

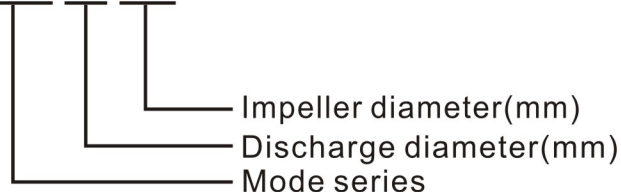

### Performance Coverages

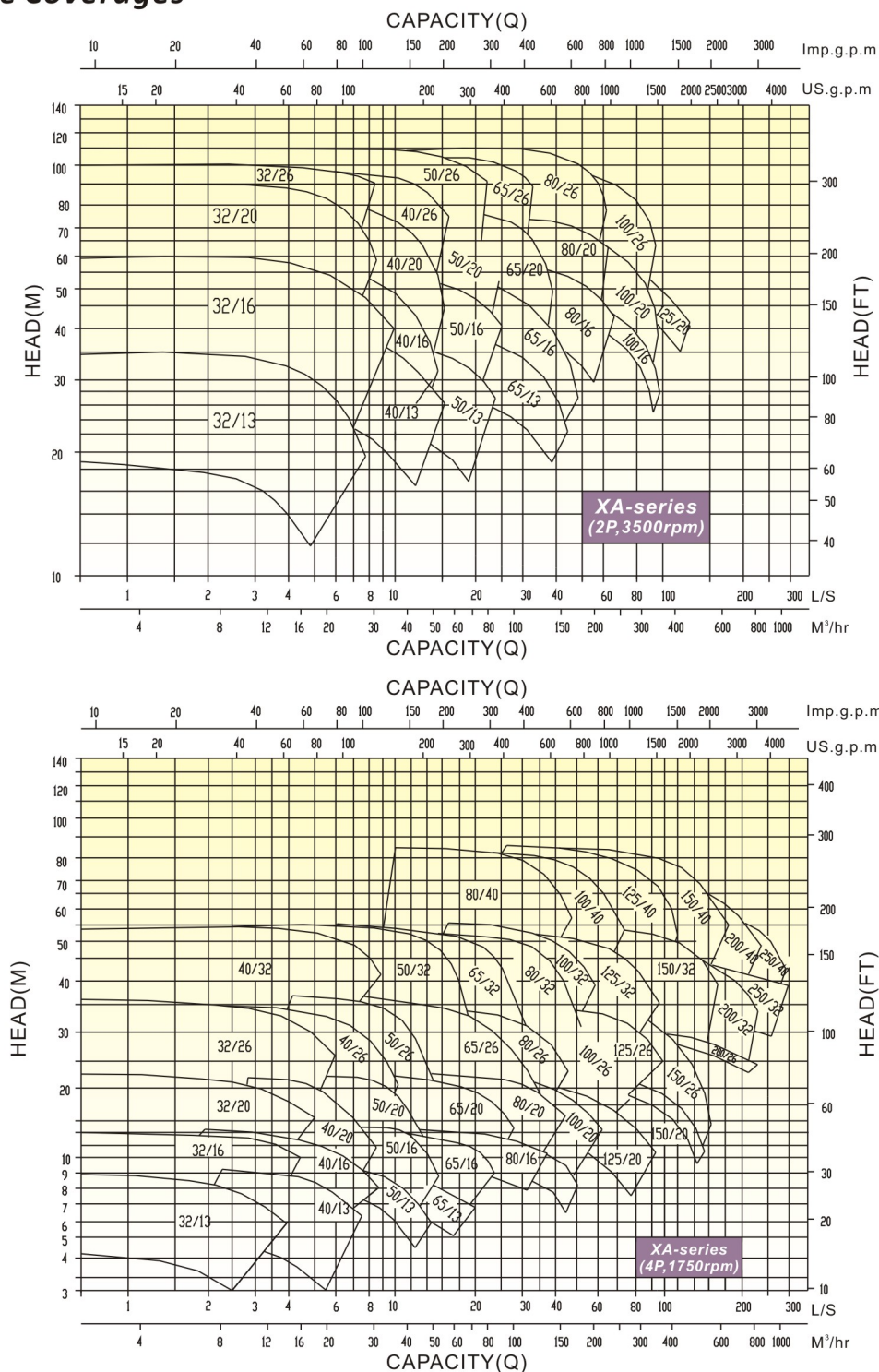



### Dimension

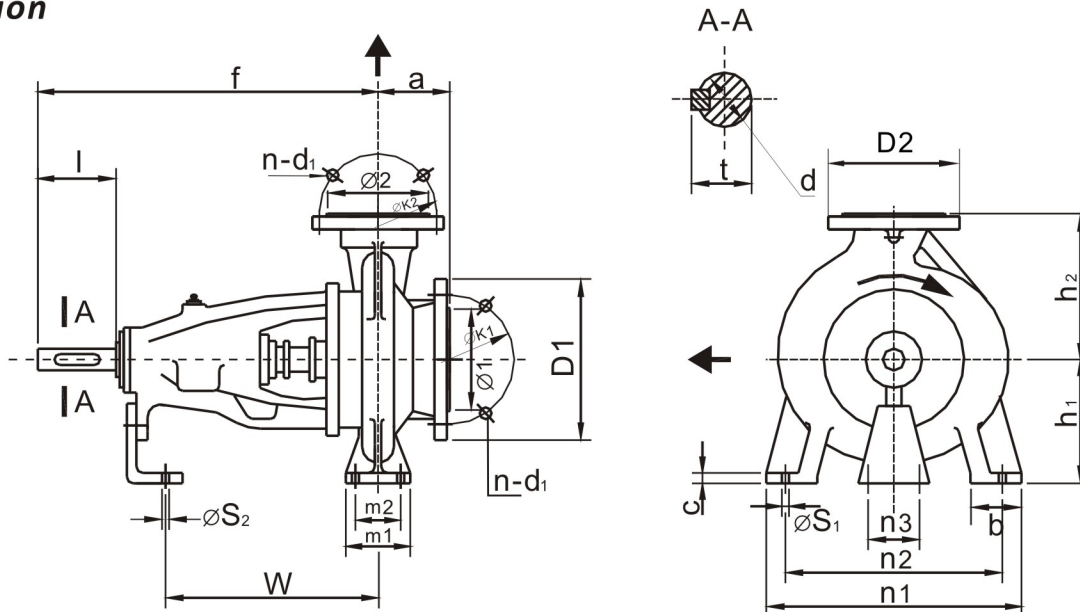

### Flange Connecting Dimension

Unit:(mm)

$\phi 1, \phi 2$	32	40	50	65	80	100	125	150	200	250	300
$\phi K1, \phi K2$	100	110	125	145	160	180	210	240	295	355	410
D1, D2	140	150	165	185	200	220	250	285	340	405	460
n-d1	4- $\phi 18$	4- $\phi 18$	4- $\phi 18$	4- $\phi 18$	8- $\phi 18$	8- $\phi 18$	8- $\phi 18$	8- $\phi 22$	12- $\phi 22$	12- $\phi 26$	12- $\phi 26$

### Overall and Mounting Dimensions Table(mm):

Unit:(mm)

Type	Shaft Diameter	Pump Dimensions						Pump Foot Dimensions										Shaft End		
		$\phi 1$	$\phi 2$	a	f	$h1$	$h2$	b	c	$m1$	$m2$	$n1$	$n2$	$n3$	$\phi S1$	$\phi S2$	w	d	l	t
XA3213	25	50	32	80	360	112	140	50	14	100	70	190	140	100	14	14	267	24	50	27
XA3216	25	50	32	80	360	132	160	50	14	100	70	240	190	100	14	14	267	24	50	27
XA3220	25	50	32	80	360	160	180	50	14	100	70	240	190	110	14	14	267	24	50	27
XA3226	25	50	32	100	360	180	225	65	14	125	95	320	250	110	14	14	267	24	50	27
XA4013	25	65	40	80	360	112	140	50	14	100	70	210	160	100	14	14	267	24	50	27
XA4016	25	65	40	80	360	132	160	50	14	100	70	240	190	100	14	14	267	24	50	27
XA4020	25	65	40	100	360	160	180	50	14	100	70	265	212	110	14	14	267	24	50	27
XA4026	25	65	40	100	360	180	225	65	14	125	95	320	250	110	14	14	267	24	50	27
XA4032	35	65	40	125	470	200	225	65	14	125	95	345	280	110	14	14	342	32	80	35
XA5013	25	65	50	100	360	132	160	50	14	100	70	240	190	100	14	14	267	24	50	27
XA5016	25	65	50	100	360	160	180	50	14	100	70	265	212	110	14	14	267	24	50	27
XA5020	25	65	50	100	360	160	200	50	14	100	70	265	212	110	14	14	267	24	50	27
XA5026	25	65	50	100	360	180	225	65	14	125	95	320	250	110	14	14	267	24	50	27
XA5032	35	65	50	125	470	225	280	65	16	125	95	345	280	110	14	14	342	32	80	35

### ● Overall and Mounting Dimensions Table(mm):

Unit:(mm)

Type	Shaft Diameter	Pump Dimensions						Pump Foot Dimensions										Shaft End		
		φ1	φ2	a	f	h <sub>1</sub>	h <sub>2</sub>	b	c	m <sub>1</sub>	m <sub>2</sub>	n <sub>1</sub>	n <sub>2</sub>	n <sub>3</sub>	φS <sub>1</sub>	φS <sub>2</sub>	w	d	l	t
XA6513	25	80	65	100	360	160	180	65	14	125	95	280	212	110	14	14	267	24	50	27
XA6516	25	80	65	100	360	160	200	65	14	125	95	280	212	110	14	14	267	24	50	27
XA6520	25	80	65	100	360	180	225	65	14	125	95	320	250	110	14	14	267	24	50	27
XA6526	35	80	65	100	470	200	250	80	16	160	120	360	280	110	17.5	14	342	32	80	35
XA6532	35	80	65	125	470	225	280	80	16	160	120	400	315	110	17.5	14	342	32	80	35
XA8016	25	100	80	125	360	180	225	65	14	125	95	320	250	110	14	14	267	24	50	27
XA8020	35	100	80	125	470	180	250	65	14	125	95	345	280	110	14	14	342	32	80	35
XA8026	35	100	80	125	470	200	280	80	16	160	120	400	315	110	17.5	14	342	32	80	35
XA8032	35	100	80	125	470	250	315	80	16	160	120	400	315	110	17.5	14	342	32	80	35
XA8040	45	100	80	125	532	280	355	85	16	160	120	440	340	110	17.5	14	368	42	110	45
XA10016	35	125	100	125	470	200	250	80	16	160	120	360	280	110	17.5	14	342	32	80	35
XA10020	35	125	100	125	470	200	280	80	16	160	120	360	280	110	17.5	14	342	32	80	35
XA10026	35	125	100	140	470	225	280	80	16	160	120	400	315	110	17.5	14	342	32	80	35
XA10032	35	125	100	140	470	250	315	80	16	160	120	400	315	110	17.5	14	342	32	80	35
XA10040	45	125	100	140	530	280	355	100	18	200	150	500	400	110	23	14	370	42	110	45
XA12520	35	150	125	140	470	250	315	80	16	160	120	400	315	110	17.5	14	342	32	80	35
XA12526	35	150	125	140	470	250	355	80	16	160	120	400	315	110	17.5	14	342	32	80	35
XA12532	45	150	125	140	530	280	355	100	18	200	150	500	400	110	23	14	370	42	110	45
XA12540	45	150	125	140	530	315	400	100	18	200	150	500	400	110	23	14	370	42	110	45
XA15020	35	200	150	160	495	280	400	100	20	200	150	550	450	110	23	14	367	32	80	35
XA15026	45	200	150	160	530	250	355	100	18	200	150	450	350	110	23	14	370	42	110	45
XA15032	45	200	150	160	530	280	400	100	18	200	150	550	450	110	23	14	370	42	110	45
XA15040	45	200	150	160	530	315	450	100	18	200	150	550	450	110	23	14	370	42	110	45
XA20026	45	250	200	180	553	315	450	100	20	200	150	550	450	110	28	14	393	42	110	45
XA20032	55	250	200	180	670	315	480	120	20	220	170	600	480	110	28	14	504	48	110	51
XA20040	55	250	200	180	670	335	480	120	20	220	170	600	480	110	28	14	504	48	110	51
XA25032	55	300	250	220	691	355	520	150	22	250	200	660	510	110	28	14	525	48	110	51
XA25040	55	300	250	220	682	400	560	150	22	250	200	660	510	110	28	14	516	48	110	51

(Remarks: More detailed individual performance curves and dimensions of all XA models are available from EVERGUSH website)