

XA bare shaft pump



XA pump with IEC standard motor



Optional-XA pump with Inverter(VFD) motor



## Features

1. Back-pull-out design for easy removal of bearing housing assembly and the volute casing for repair without having to disturb the connected pipeline. This advantage enables fast and easy dismantling for servicing, resulting in lower maintenance costs.
2. Single stage end suction centrifugal pump with foot mounted, is designed to comply with international standard EN733 which substitutes for DIN24255.
3. Quality bearing- each shaft module consists of two identical bearings, grease or oil lubricated, lifetime design for more reliability and less maintenance.
4. It requires only 5 kinds of bearing housings, 6 kinds of shafts and 4 kinds of bearings to make the assembly of the entire 42 models. It will effectively minimize accessory inventory and enhance pump components interchangeability.
5. To suit the demand for the variety of applications, XA model provides Grey Cast Iron as standard and various optional materials construction upon aggressive and abrasive medium.
6. Shaft sealing with mechanical seal as standard for protecting against environment damage due to leakage. Gland packing is also available upon request.

## Applications

1. Heating and cooling water circulation.
2. Broad range of industrial applications.
3. Open loop and close loop water circuit systems.
4. Water supply and pressure boosting systems.
6. Process water for paper mill, brewery, refinery.
7. Boiler feed, washing and cleaning system.
8. General purpose water transfer and drainage.
9. Water supply for fire-fighting systems.
10. Irrigation and Agriculture.

## Components Illustration

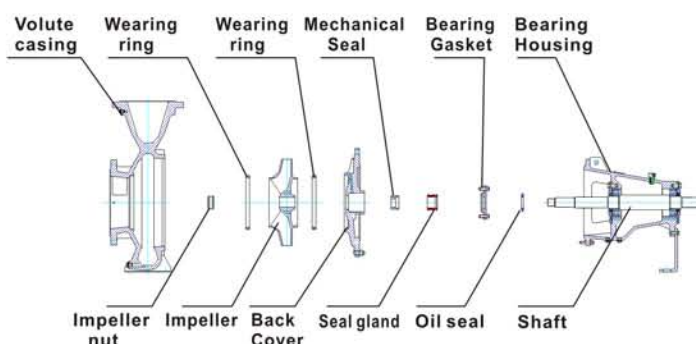

## Sectional View

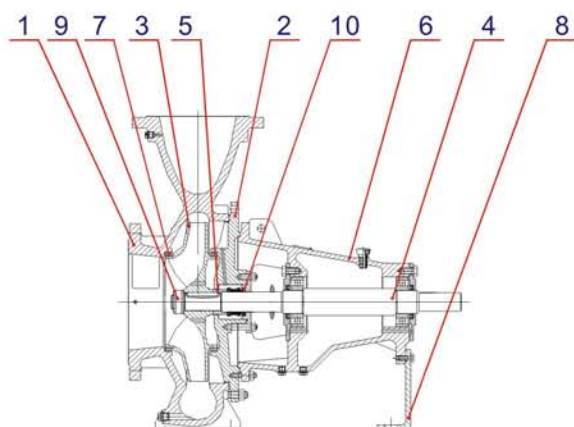

NO	Part Name	Standard material	Substitute material
1	Volute casing	FC250	SUS304
2	Back cover	FC250	SUS304
3	Impeller	FC250 or Bronze	SUS304
4	Shaft	SUS420	SUS304
5	Shaft sleeve	Bronze	SUS304
6	Bearing housing	FC250	-----
7	O-ring	NBR	Teflon
8	Support foot	SS400	-----
9	Impeller nut	SUS304	-----
10	Mechanical seal	CA/CE	SIC/SIC

• Ductile cast iron is available for pump material selection.



### Operating Conditions

1. For clean non-corrosive or non-aggressive liquids, without solid particles or abrasives.
2. Capacity: Max. 1200m<sup>3</sup>/hr.
3. Total head: up to 110m.
4. Discharge flanges: 32mm to 250mm.
5. Suction flanges: 50mm to 300mm.
5. Working pressure: 10 bar in standard.
6. Liquid temperature: 0~+100°C.

### Model Code

**XA6520**

Impeller diameter(mm)  
Discharge diameter(mm)  
Mode series

### Performance Coverages

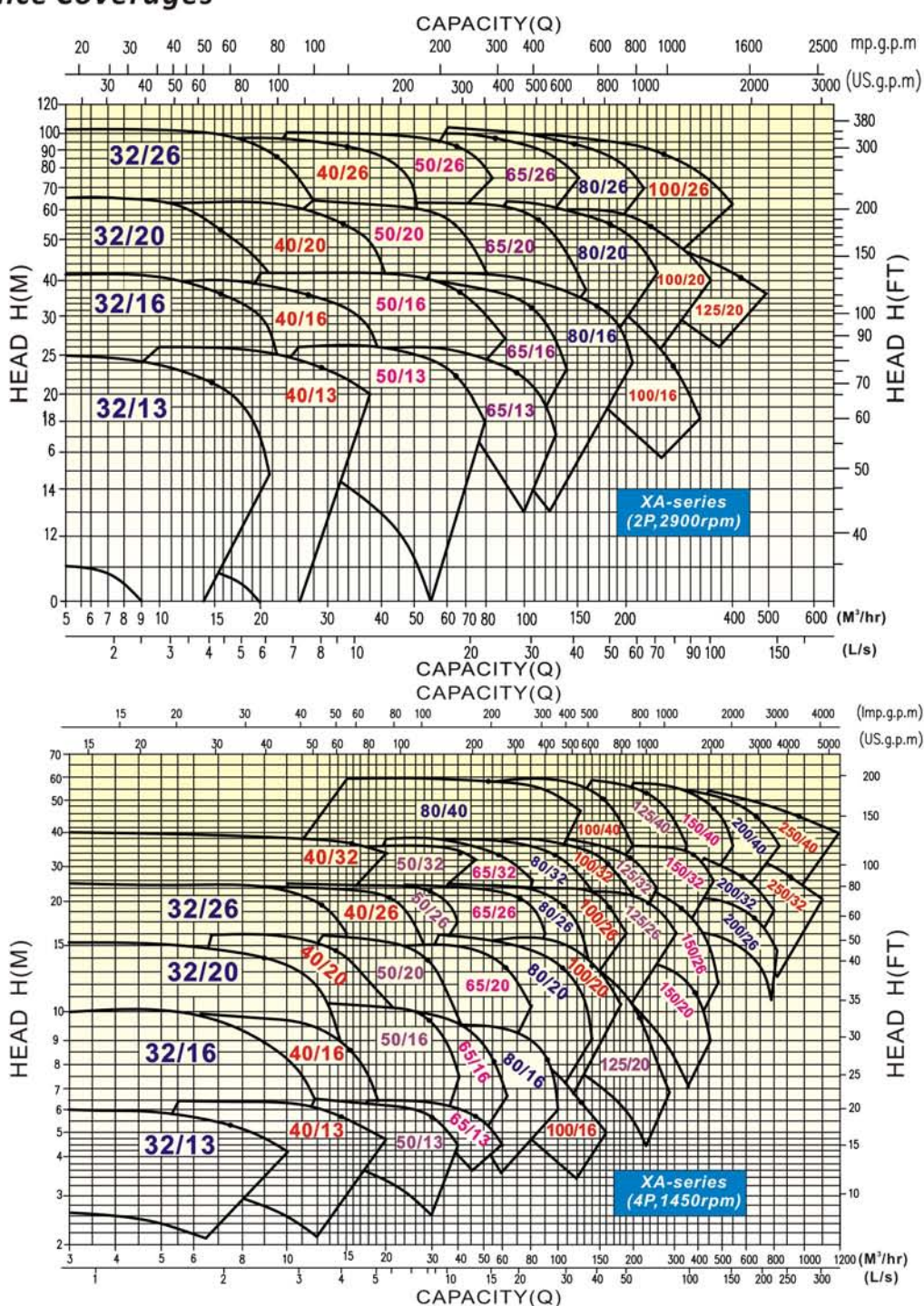



**Dimensions**

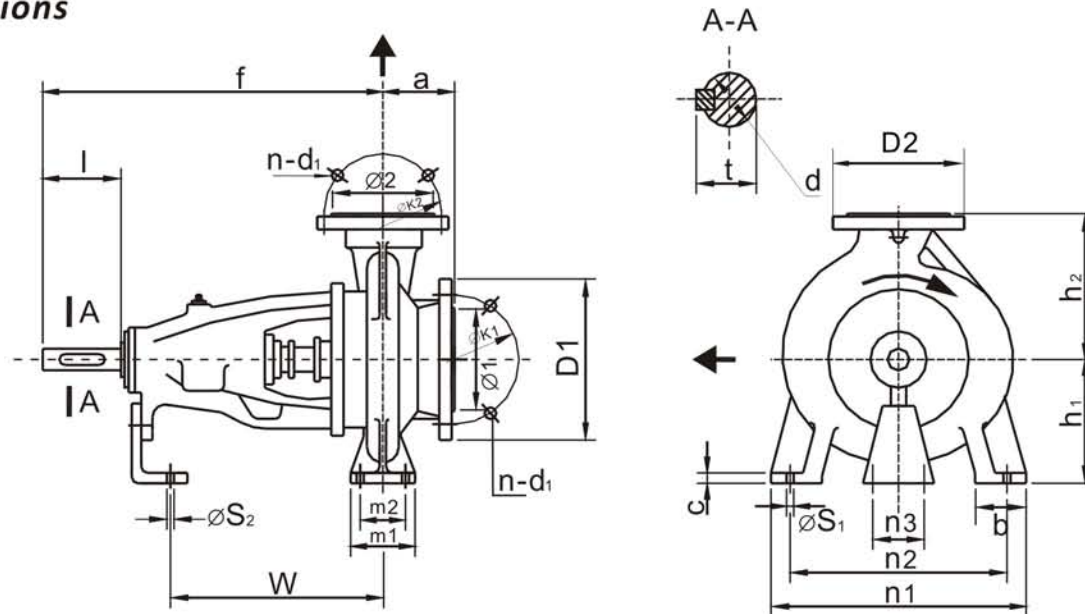

**Flange Connecting Dimensions**

Unit:(mm)

$\phi 1, \phi 2$	32	40	50	65	80	100	125	150	200	250	300
$\phi K_1, \phi K_2$	100	110	125	145	160	180	210	240	295	355	410
D1, D2	140	150	165	185	200	220	250	285	340	405	460
n-d1	4- $\phi 18$	4- $\phi 18$	4- $\phi 18$	4- $\phi 18$	8- $\phi 18$	8- $\phi 18$	8- $\phi 18$	8- $\phi 22$	12- $\phi 22$	12- $\phi 26$	12- $\phi 26$

**Overall and Mounting Dimensions Table(mm):**

Unit:(mm)

Type	Shaft Diameter	Pump Dimensions						Pump Foot Dimensions										Shaft End		
		$\phi 1$	$\phi 2$	a	f	$h_1$	$h_2$	b	c	$m_1$	$m_2$	$n_1$	$n_2$	$n_3$	$\phi S_1$	$\phi S_2$	w	d	l	t
XA3213	25	50	32	80	360	112	140	50	14	100	70	190	140	100	14	14	267	24	50	27
XA3216	25	50	32	80	360	132	160	50	14	100	70	240	190	100	14	14	267	24	50	27
XA3220	25	50	32	80	360	160	180	50	14	100	70	240	190	110	14	14	267	24	50	27
XA3226	25	50	32	100	360	180	225	65	14	125	95	320	250	110	14	14	267	24	50	27
XA4013	25	65	40	80	360	112	140	50	14	100	70	210	160	100	14	14	267	24	50	27
XA4016	25	65	40	80	360	132	160	50	14	100	70	240	190	100	14	14	267	24	50	27
XA4020	25	65	40	100	360	160	180	50	14	100	70	265	212	110	14	14	267	24	50	27
XA4026	25	65	40	100	360	180	225	65	14	125	95	320	250	110	14	14	267	24	50	27
XA4032	35	65	40	125	470	200	225	65	14	125	95	345	280	110	14	14	342	32	80	35
XA5013	25	65	50	100	360	132	160	50	14	100	70	240	190	100	14	14	267	24	50	27
XA5016	25	65	50	100	360	160	180	50	14	100	70	265	212	110	14	14	267	24	50	27
XA5020	25	65	50	100	360	160	200	50	14	100	70	265	212	110	14	14	267	24	50	27
XA5026	25	65	50	100	360	180	225	65	14	125	95	320	250	110	14	14	267	24	50	27
XA5032	35	65	50	125	470	225	280	65	16	125	95	345	280	110	14	14	342	32	80	35

### ● Overall and Mounting Dimensions Table(mm):

Unit:(mm)

Type	Shaft Diameter	Pump Dimensions						Pump Foot Dimensions										Shaft End		
		φ1	φ2	a	f	h <sub>1</sub>	h <sub>2</sub>	b	c	m <sub>1</sub>	m <sub>2</sub>	n <sub>1</sub>	n <sub>2</sub>	n <sub>3</sub>	φS <sub>1</sub>	φS <sub>2</sub>	w	d	l	t
XA6513	25	80	65	100	360	160	180	65	14	125	95	280	212	110	14	14	267	24	50	27
XA6516	25	80	65	100	360	160	200	65	14	125	95	280	212	110	14	14	267	24	50	27
XA6520	25	80	65	100	360	180	225	65	14	125	95	320	250	110	14	14	267	24	50	27
XA6526	35	80	65	100	470	200	250	80	16	160	120	360	280	110	17.5	14	342	32	80	35
XA6532	35	80	65	125	470	225	280	80	16	160	120	400	315	110	17.5	14	342	32	80	35
XA8016	25	100	80	125	360	180	225	65	14	125	95	320	250	110	14	14	267	24	50	27
XA8020	35	100	80	125	470	180	250	65	14	125	95	345	280	110	14	14	342	32	80	35
XA8026	35	100	80	125	470	200	280	80	16	160	120	400	315	110	17.5	14	342	32	80	35
XA8032	35	100	80	125	470	250	315	80	16	160	120	400	315	110	17.5	14	342	32	80	35
XA8040	45	100	80	125	532	280	355	85	16	160	120	440	340	110	17.5	14	368	42	110	45
XA10016	35	125	100	125	470	200	250	80	16	160	120	360	280	110	17.5	14	342	32	80	35
XA10020	35	125	100	125	470	200	280	80	16	160	120	360	280	110	17.5	14	342	32	80	35
XA10026	35	125	100	140	470	225	280	80	16	160	120	400	315	110	17.5	14	342	32	80	35
XA10032	35	125	100	140	470	250	315	80	16	160	120	400	315	110	17.5	14	342	32	80	35
XA10040	45	125	100	140	530	280	355	100	18	200	150	500	400	110	23	14	370	42	110	45
XA12520	35	150	125	140	470	250	315	80	16	160	120	400	315	110	17.5	14	342	32	80	35
XA12526	35	150	125	140	470	250	355	80	16	160	120	400	315	110	17.5	14	342	32	80	35
XA12532	45	150	125	140	530	280	355	100	18	200	150	500	400	110	23	14	370	42	110	45
XA12540	45	150	125	140	530	315	400	100	18	200	150	500	400	110	23	14	370	42	110	45
XA15020	35	200	150	160	495	280	400	100	20	200	150	550	450	110	23	14	367	32	80	35
XA15026	45	200	150	160	530	250	355	100	18	200	150	450	350	110	23	14	370	42	110	45
XA15032	45	200	150	160	530	280	400	100	18	200	150	550	450	110	23	14	370	42	110	45
XA15040	45	200	150	160	530	315	450	100	18	200	150	550	450	110	23	14	370	42	110	45
XA20026	45	250	200	180	553	315	450	100	20	200	150	550	450	110	28	14	393	42	110	45
XA20032	55	250	200	180	670	315	480	120	20	220	170	600	480	110	28	14	504	48	110	51
XA20040	55	250	200	180	670	335	480	120	20	220	170	600	480	110	28	14	504	48	110	51
XA25032	55	300	250	220	691	355	520	150	22	250	200	660	510	110	28	14	525	48	110	51
XA25040	55	300	250	220	682	400	560	150	22	250	200	660	510	110	28	14	516	48	110	51

(Remarks: More detailed individual performance curves and dimensions of all XA models are available from EVERGUSH website)



## ● Specification

Unit:(mm)

Model	Capacity		Head H (M)	Speed N (R/MIN)	Output		Efficiency (%)	NPSHR (M)	Imp. Dim. (MM)	Inlet/ Outlet Dim.		Weight G(kg)																								
	M <sup>3</sup> /H	L/S			SHAFT (KW)	MOTOR (KW)				SUCTION	DISCHARGE																									
XA32/13	9	2.5	24.9	2900	1.39	2.2	44	1.2	139	50	32	27.5																								
	15	4.2	23		1.71	2.2	55	1.8																												
	18	5	21		1.84	2.2	56	2.3																												
XA32/13A	8.5	2.4	21.2	2900	1.13	1.5	43.5	1.8	130				50	32	27.5																					
	14	3.9	19		1.34	1.5	54	1.95																												
	17	4.7	17.3		1.51	2.2	53	2.3																												
XA32/13B	7.8	2.2	17.3	2900	0.87	1.1	42	1.8	120							50	32	27.5																		
	13	3.6	15.3		1.06	1.5	51	1.88																												
	15.5	4.3	13.8		1.12	1.5	52	2.08																												
XA32/16	10.8	3	40	2900	2.5	3	47	1.2	174			50							32	35																
	18	5	38.5		3.23	4	58.5	2																												
	21.6	6	36		3.59	5.5	59	2.6																												
XA32/16A	10.5	2.9	35.7	2900	2.22	3	46	1.9	165						50						32	35														
	17	4.7	33		2.78	4	55	1.95																												
	21	5.8	30		3.06	4	56	2.4																												
XA32/16B	9.8	2.7	32.4	2900	1.97	2.2	44	1.9	155									50					32	35												
	16	4.4	29.5		2.43	4	53	1.95																												
	19.5	5.4	27		2.66	4	54	2.2																												
XA32/20	10.8	3	66	2900	4.51	5.5	43	1.3	214											50					32	41										
	18	5	61.5		5.74	7.5	52.5	1.9																												
	21.6	6	57		6.27	11	53.5	2.3																												
XA32/20A	10.2	2.8	58.2	2900	4.04	5.5	40	1.8	205													50					32	41								
	17	4.7	55.8		4.87	7.5	53	1.95																												
	20.4	5.7	52.2		5.47	7.5	53	2.2																												
XA32/20B	9.9	2.8	51.5	2900	3.65	5.5	38	1.8	195															50					32	41						
	16.5	4.6	48		4.4	5.5	49	1.9																												
	19.8	5.5	45		4.97	7.5	48.8	2.15																												
XA32/26	13.2	3.7	102	2900	11.21	15	32.7	1.8	264																	50					32	59				
	22	6.1	96		14.1	18.5	40.8	2.7																												
	26.4	7.3	89		15.61	18.5	41	3.3																												
XA32/26A	12.6	3.5	92.5	2900	10.11	15	31.4	2.1	255																			50					32	59		
	21	5.8	88		12.58	15	40	2.2																												
	25.2	7	83		13.89	15	41	2.5																												
XA32/26B	12.3	3.4	84.5	2900	9.43	15	30	2.15	245																					50					32	59
	20.5	5.7	81		11.75	15	38.5	2.16																												
	24.6	6.8	77		12.9	15	40	2.38																												

## ● Specification

Unit:(mm)

Model	Capacity		Head H (M)	Speed N (R/MIN)	Output		Efficiency (%)	NPSHR (M)	Imp. Dim. (MM)	Inlet/ Outlet Dim.		Weight G(kg)						
	M <sup>3</sup> /H	L/S			SHAFT (KW)	MOTOR (KW)				SUCTION	DISCHARGE							
XA40/13	18	5	26	2900	2.09	3	61	1.4	139	65	40	30						
	30	8.3	24.5		2.65	4	75.5	2.5										
	36	10	23		2.91	4	77.5	3.5										
XA40/13A	16.8	4.7	22.5	2900	1.74	2.2	59	1.8	130				65	40	30			
	28	7.8	21		2.29	3	70	2										
	33.6	9.3	20		2.54	4	72	2.25										
XA40/13B	15.5	4.3	18.5	2900	1.47	1.5	53	1.8	120							65	40	30
	26	7.2	17.5		1.91	3	65	1.9										
	31	8.6	16.5		2.14	3	65	2.15										
XA40/16	18	5	41	2900	3.72	5.5	54	2.7	174	65	40	36						
	30	8.3	38.5		4.91	7.5	64	3.2										
	36	10	35.5		5.4	7.5	64.5	3.7										
XA40/16A	17	4.7	36	2900	3.21	4	52	2.1	165				65	40	36			
	28.5	7.9	33.5		4	5.5	65	2.5										
	34	9.4	31		4.63	5.5	62	3.25										
XA40/16B	16	4.4	31.5	2900	2.86	4	48	2.05	155							65	40	36
	26.5	7.4	29		3.52	4	59.5	2.4										
	32	8.9	25.5		3.77	4	59	2.9										
XA40/20	18	5	64	2900	6.54	7.5	48	1.85	214	65	40	44						
	30	8.3	61		8.38	11	59.5	2.7										
	36	10	58.6		9.27	11	62	3.2										
XA40/20A	17	4.7	58.5	2900	5.58	7.5	48.5	1.8	205				65	40	44			
	29	8.1	56		7.25	11	61	1.95										
	34.5	9.6	53.5		7.98	11	63	2.45										
XA40/20B	16.5	4.6	52.5	2900	5.13	5.5	46	1.8	195							65	40	44
	27.5	7.6	49		6.22	7.5	59	1.9										
	33	9.2	47		6.92	11	61	2.2										
XA40/26	21.6	6	98.5	2900	12.88	15	45	1.5	264	65	40	61						
	36	10	95.5		16.72	18.5	56	2										
	43.2	12	91		18.15	22	59	2.4										
XA40/26A	19.5	5.4	89	2900	11.25	15	42	1.8	255				65	40	61			
	32	8.9	87		14.31	18.5	53	1.95										
	38.5	10.7	84		16.01	18.5	55	2.35										
XA40/26B	18.5	5.1	80	2900	10.08	15	40	1.8	245							65	40	61
	30.5	8.5	78		12.22	15	53	1.9										
	37	10.3	76		14.18	18.5	54	2.2										



## ● Specification

Unit:(mm)

Model	Capacity		Head H (M)	Speed N (R/MIN)	Output		Efficiency (%)	NPSHR (M)	Imp. Dim. (MM)	Inlet/ Outlet Dim.		Weight G(kg)						
	M <sup>3</sup> /H	L/S			SHAFT (KW)	MOTOR (KW)				SUCTION	DISCHARGE							
XA40/32	21.6	6	150	2900	25.95	30	34	2	329	65	40	95.8						
	36	10	139		30.97	37	44	2.8										
	43.2	12	127		33.2	37	45	3.8										
XA40/32A	19.4	5.4	124	2900	19.31	18.2	34	1.7	300				65	40	95.8			
	32.4	9	115		23.6	30	43	2.8										
	38.9	10.8	107		25.75	30	44	3.8										
XA40/32B	17.3	4.8	109	2900	16.03	22	32	1.2	280							65	40	95.8
	28.8	8	102		19.51	22	41	2.3										
	34.6	9.6	95		21.29	22	42	3.2										
XA50/13	36	10	26	2900	3.78	5.5	67.5	2.4	139	65	50	34						
	60	16.7	23.5		5.05	5.5	76	3.3										
	72	20	21.5		5.66	7.5	74.5	3.9										
XA50/13A	33.5	9.3	21.5	2900	3.04	4	64.5	2.5	130				65	50	34			
	56	15.6	18.5		4	5.5	70.5	3.1										
	67.5	18.8	15.5		4.35	5.5	65.5	3.6										
XA50/13B	31	8.6	18.5	2900	2.56	3	61	2.5	120							65	50	34
	52	14.4	16.5		3.34	4	70	2.9										
	62	17.2	15		3.67	5.5	69	3.3										
XA50/16	40	11.1	42.5	2900	6.76	11	68.5	2	174	65	50	38						
	65	18.1	39		9.08	11	76	3.5										
	78	21.7	35.5		10.26	11	73.5	4.7										
XA50/16A	38	10.6	38	2900	5.62	7.5	70	2.5	165				65	50	38			
	61.5	17.1	34.5		7.6	11	76	3.3										
	74	20.6	30		8.17	11	74	3.9										
XA50/16B	35.5	9.9	34	2900	4.63	5.5	71	2.35	155							65	50	38
	58	16.1	30.5		6.42	11	75	3.1										
	69.5	19.3	28		7.26	11	73	3.7										
XA50/20	36	10	61	2900	9.34	15	64	1.9	214	65	50	46						
	60	16.7	55		12.84	15	70	3.2										
	72	20	51		14.39	18.5	69.5	4.1										
XA50/20A	34.5	9.6	57	2900	8.93	11	60	2.5	205				65	50	46			
	57.5	16	53		11.53	15	72	3.1										
	69	19.2	50.5		13	15	73	3.75										
XA50/20B	33	9.2	49.5	2900	7.18	11	62	2.5	195							65	50	46
	54.5	15.1	43		9.39	15	68	3										
	65.5	18.2	38		10.27	15	66	3.5										

## ● Specification

Unit:(mm)

Model	Capacity		Head H (M)	Speed N (R/MIN)	Output		Efficiency (%)	NPSHR (M)	Imp. Dim. (MM)	Inlet/ Outlet Dim.		Weight G(kg)						
	M <sup>3</sup> /H	L/S			SHAFT (KW)	MOTOR (KW)				SUCTION	DISCHARGE							
XA50/26	40	11.1	103	2900	20.78	30	54	2.2	264	65	50	63						
	65	18.1	97.5		27.18	30	63.5	4										
	78	21.7	91		30.68	37	63	4.9										
XA50/26A	38.5	10.7	91.5	2900	19.19	22	50	2.4	255				65	50	63			
	63	17.5	85.5		24.45	30	60	3.3										
	75.5	21	80		26.75	30	61.5	3.9										
XA50/26B	37	10.3	84	2900	16.93	18.5	50	2.3	245							65	50	63
	60.5	16.8	77		21.14	30	60	3.2										
	72.5	20.1	71		24.17	30	58	3.9										
XA50/32	54	15	146	2900	40.51	45	53	3.5	329	65	50	101						
	90	25	137		55.05	75	61	7										
	108	30	130		61.67	75	52	8										
XA50/32A	48.6	13.5	130	2900	34.41	45	50	3.3	300				65	50	101			
	81	22.5	124		45.59	55	60	6.5										
	97.2	27	117		50.77	75	61	7.5										
XA50/32B	46.8	13	105	2900	25.74	30	52	2.5	280							65	50	101
	78.1	21.7	98		35.04	45	59.5	5										
	93.6	26	91		39.32	45	59	6.5										
XA65/13	60	16.7	25.5	2900	6.27	7.5	66.5	2.6	139	80	65	39						
	100	27.8	21		8.17	11	70	3.9										
	120	33.3	16		8.86	11	59	4.8										
XA65/13A	56	15.6	21.8	2900	5.11	7.5	65	3	130				80	65	39			
	93.5	26	17.5		6.37	11	70	3.5										
	113	31.3	13		6.99	11	57	4.1										
XA65/13B	52	14.4	18	2900	4.08	5.5	62.5	3	120							80	65	39
	86.5	24	13.7		4.89	7.5	66	3.3										
	104	28.9	10.6		5.27	7.5	57	3.75										
XA65/16	64.8	18	39	2900	9.97	15	69	3.2	174	80	65	43						
	108	30	33.5		12.71	15	77.5	4.2										
	130	36	29		14.22	18.5	72	5										
XA65/16A	57	15.8	34	2900	8.38	11	63	3.6	165				80	65	43			
	95	26.4	30.5		10.66	15	74	4.1										
	114	31.7	27		11.81	15	71	4.8										
XA65/16B	53.5	14.9	30	2900	7.28	11	60	3.6	155							80	65	43
	89	24.7	25.5		8.83	11	70	3.95										
	107	29.7	22.5		9.5	11	69	4.5										



## ● Specification

Unit:(mm)

Model	Capacity		Head H (M)	Speed N (R/MIN)	Output		Efficiency (%)	NPSHR (M)	Imp. Dim. (MM)	Inlet/ Outlet Dim.		Weight G(kg)						
	M <sup>3</sup> /H	L/S			SHAFT (KW)	MOTOR (KW)				SUCTION	DISCHARGE							
XA65/20	66	18.3	64	2900	17.7	22	65	2.2	214	80	65	70						
	110	30.6	59		23.72	30	74.5	4.2										
	132	36.7	54.5		26.66	30	73.5	6.2										
XA65/20A	63	17.5	60	2900	16.08	18.5	64	3	205				80	65	70			
	106	29.3	55.5		21.55	30	74	3.75										
	127	35.1	52		24.37	30	73.5	4.85										
XA65/20B	60	16.7	50	2900	13.18	18.5	62	3	195							80	65	70
	100	27.8	45.5		16.41	22	72.5	3.6										
	120	33.3	42		18.3	22	75	4.4										
XA65/26	72	20	98	2900	29.79	37	64.5	3.3	264	80	65	81						
	120	33.3	90		40.29	45	73	4.5										
	144	40	83		44.59	55	73	5.4										
XA65/26A	69.5	19.3	92	2900	26.79	37	65	3.25	255				80	65	81			
	116	32.2	86		38.81	45	70	4.4										
	139	38.6	79		41.53	45	72	4.95										
XA65/26B	67	18.6	82.5	2900	23.89	30	63	3.2	245							80	65	81
	112	31	76		32.5	37	71	4.25										
	134	37.1	71		36.88	45	70	4.95										
XA65/32	81	22.5	147	2900	60.05	75	54	3.8	329	80	65	110						
	135	37.5	131		76.45	90	63	4.4										
	162	45	115		84.56	110	60	5.5										
XA65/32A	81	22.5	120	2900	48.13	55	55	3.7	300				80	65	110			
	135	37.5	108		64.04	75	62	4.3										
	162	45	97		73.78	90	58	5.2										
XA65/32B	81	22.5	107	2900	40	45	59	3.5	280							80	65	110
	135	37.5	94		56.65	55	61	4.3										
	162	45	83		67.81	75	54	4.8										
XA80/16	100	27.8	39.5	2900	15.15	18.5	71	3.3	174	100	80	54						
	162	45	35		19.8	22	78	4.3										
	195	54.2	31		21.95	30	75	5.2										
XA80/16A	95	26.4	33	2900	13.13	18.5	65	3.3	165				100	80	54			
	154	42.6	28		16.26	18.5	72	3.85										
	185	51.4	24		17.78	22	68	4.6										
XA80/16B	89	24.7	29.5	2900	11.17	15	64	3.25	155							100	80	54
	145	40.1	25		13.29	15	74	3.7										
	174	48.3	21		14.22	18.5	70	4.3										

## ● Specification

Unit:(mm)

Model	Capacity		Head H (M)	Speed N (R/MIN)	Output		Efficiency (%)	NPSHR (M)	Imp. Dim. (MM)	Inlet/ Outlet Dim.		Weight G(kg)						
	M <sup>3</sup> /H	L/S			SHAFT (KW)	MOTOR (KW)				SUCTION	DISCHARGE							
XA80/20	115	31.9	60	2900	26.84	37	70	3.2	214	100	80	70						
	190	52.8	55		36.49	37	78	5.1										
	225	62.5	50		41.12	45	74.5	6.5										
XA80/20A	110	30.6	57	2900	25.11	30	68	4	205				100	80	70			
	182	50.6	53.5		34.44	37	77	4.9										
	216	59.9	44.5		37.31	37	70	5.85										
XA80/20B	105	29.2	49.5	2900	20.82	30	68	4	195							100	80	70
	173	48.1	45		27.9	30	76	4.7										
	205	56.9	40		31.9	37	70	5.5										
XA80/26	115	31.9	97	2900	46.74	55	65	3.8	264	100	80	91						
	190	52.8	88		60.71	75	75	6.1										
	225	62.5	81		67.53	75	73.5	8										
XA80/26A	111	30.8	91.5	2900	43.9	55	63	3.95	255				100	80	91			
	184	51	81.5		54.3	75	75	5.2										
	218	60.4	73		59.23	75	73	6.25										
XA80/26B	107	29.6	79	2900	37.56	45	61	3.9	245							100	80	91
	177	49	68.5		45.1	55	73	5										
	209	58.1	60		48.1	75	71	6										
XA80/32	126	35	146	2900	78.28	90	64	5.6	329	125	100	120						
	210	58.3	134		103.6	132	74	6.3										
	252	70	121		113.8	132	73	7										
XA80/32A	117	32.5	125	2900	64.24	75	62	6.1	300				125	100	120			
	195	54.2	114		82.93	90	73	6.3										
	234	65	103		91.16	110	72	6.9										
XA80/32B	108	30	104	2900	47.79	55	64	5	280							125	100	120
	180	50	95		63.79	75	73	5.8										
	216	60	85		71.43	90	70	6.3										
XA100/20	180	50	61	2900	41.53	55	72	4	214	125	100	85						
	295	81.9	51.5		52.37	75	79	5.8										
	340	94.4	42		52.55	75	74	7										
XA100/20A	173	47.9	51	2900	34.72	45	69	3.95	205				125	100	85			
	273	75.8	42		42.2	55	74	4.9										
	326	90.4	36		46.25	55	69	5.95										
XA100/20B	164	45.6	46	2900	30.21	37	68	3.9	195							125	100	85
	260	72.2	35		35.4	45	70	4.8										
	310	86.1	31		39.06	45	67	5.6										



## ● Specification

Unit:(mm)

Model	Capacity		Head H (M)	Speed N (R/MIN)	Output		Efficiency (%)	NPSHR (M)	Imp. Dim. (MM)	Inlet/ Outlet Dim.		Weight G(kg)						
	M <sup>3</sup> /H	L/S			SHAFT (KW)	MOTOR (KW)				SUCTION	DISCHARGE							
XA100/26	190	52.8	97	2900	70.69	90	71	3.7	264	125	100	106						
	295	81.9	86		90.91	110	76	5.5										
	350	97.2	80		103	110	74	7.5										
XA100/26A	184	51	85.5	2900	61.92	75	69	3.75	255				125	100	106			
	285	79.2	75		78.66	90	74	5										
	338	93.9	66		85.57	110	71	6.2										
XA100/26B	177	49.2	76	2900	54.68	75	67	3.7	245							125	100	106
	274	76.1	66		68.4	90	72	4.8										
	325	90.3	58		75.49	90	68	5.9										
XA125/20	238	66	57.5	2900	57.68	75	64.5	7	214	150	125	106						
	360	100	50.5		66.46	90	74.5	7.2										
	475	132	40		76.12	90	68	7.8										

## ● Specification

Unit:(mm)

Model	Capacity		Head H (M)	Speed N (R/MIN)	Output		Efficiency (%)	NPSHR (M)	Imp. Dim. (MM)	Inlet/ Outlet Dim.		Weight G(kg)
	M <sup>3</sup> /H	L/S			SHAFT (KW)	MOTOR (KW)				SUCTION	DISCHARGE	
XA32/13	4.5	1.3	6.5	1450	0.22	0.55	35	0.62	139	50	32	27.5
	7.5	2.1	5.6		0.25	0.55	46	0.75				
	9	2.5	5.2		0.26	0.55	49	0.9				
XA32/16	6	1.7	9.7	1450	0.38	0.55	42	0.7	174	50	32	35
	9	2.5	9		0.46	0.55	48	1				
	11	3.1	8		0.48	0.55	49.5	1.4				
XA32/20	6	1.7	16.3	1450	0.67	0.75	40	0.8	214	50	32	41
	9	2.5	15.4		0.79	1.1	48	1				
	11	3.1	14.5		0.85	1.1	51	1.2				
XA32/26	7.2	2	25	1450	1.63	2.2	30	0.85	264	50	32	59
	12	3.3	23.5		1.94	2.2	39.5	1.6				
	14.4	4	22		2.05	3	42	2.3				
XA40/13	10.8	3	6.55	1450	0.34	0.55	57	0.6	139	65	40	30
	18	5	5.8		0.42	0.55	67	0.9				
	21.6	6	5.4		0.47	0.55	67	1.3				
XA40/16	10.8	3	10.2	1450	0.55	0.55	55	0.9	175	65	40	36
	18	5	8.8		0.7	0.75	62	1.4				
	21.6	6	7.8		0.76	1.1	60	1.8				
XA40/20	10.8	3	16.2	1450	0.95	1.1	50	1.1	214	65	40	44
	18	5	14		1.23	1.5	56	1.3				
	21.6	6	12.4		1.33	1.5	55	0.5				
XA40/26	12.6	3.5	24.4	1450	1.99	2.2	42	0.85	264	65	40	61
	21	5.8	22		2.42	2.2	52	1.3				
	25.2	7	20		2.61	3	52.5	1.8				
XA40/32	9	2.5	38	1450	3.1	4	30	0.9	329	65	40	95.8
	14.4	4	37.5		3.5	4	42	1.3				
	18	5	37		4.03	5.5	45	1.6				
XA40/32A	10.5	2.9	34.5	1450	3.23	4	30.5	3.3	315	65	40	95.8
	17	4.7	32		3.85	5.5	38.5	2				
	20.5	5.7	29		4.32	5.5	37.5	2.9				
XA40/32B	10	2.8	31	1450	2.91	4	29	3.6	300	65	40	95.8
	16.5	4.6	29		3.52	5.5	37	2				
	20	5.6	26		3.93	5.5	36	2.7				
XA50/13	18	5	6.6	1450	0.54	0.75	60	1.2	139	65	50	34
	30	8.3	6.3		0.68	0.75	75.5	1.6				
	36	10	5.7		0.76	1.1	74	1.9				



## ● Specification

Unit:(mm)

Model	Capacity		Head H (M)	Speed N (R/MIN)	Output		Efficiency (%)	NPSHR (M)	Imp. Dim. (MM)	Inlet/ Outlet Dim.		Weight G(kg)						
	M <sup>3</sup> /H	L/S			SHAFT (KW)	MOTOR (KW)				SUCTION	DISCHARGE							
XA50/16	20	5.6	10.4	1450	0.89	1.1	64	1.25	174	65	50	38						
	32	8.9	9.8		1.15	1.5	74.3	1.7										
	38	10.6	9.4		1.31	1.5	74.5	2										
XA50/20	18	5	16	1450	1.35	1.5	58	1.4	214	65	50	46						
	30	8.3	14		1.79	2.2	64	1.8										
	36	10	13.5		2.04	2.2	65	2.1										
XA50/26	20	5.6	25	1450	2.59	3	52.5	0.9	264	65	50	63						
	32	8.9	24		3.24	4	64.5	1.5										
	38	10.6	23		3.58	5.5	66.5	2										
XA50/32	32.4	9	37	1450	5.78	5.5	56.5	2	329	65	50	101						
	54	15	30.5		7.8	7.5	57.5	2.3										
	64.8	18	23.5		8.73	11	47.5	2.5										
XA50/32A	23	6.4	33.5	1450	4.2	5.5	50	2	315				65	50	101			
	38.5	10.7	31.3		5.29	7.5	62	2.4										
	46	12.8	30		5.97	7.5	63	3										
XA50/32B	22	6.1	29.8	1450	3.57	5.5	50	2	300							65	50	101
	36.5	10.1	28.5		4.64	7.5	61	2.3										
	44	12.2	27		5.22	7.5	62	2.8										
XA65/13	21.6	6	6.7	1450	0.79	1.1	50	1.2	139	80	65	39						
	36	10	6.4		0.95	1.1	66	1.35										
	43.2	12	6		1.02	1.5	69	1.5										
XA65/16	32.4	9	10	1450	1.38	2.2	64	1.1	174	80	65	43						
	54	15	9.2		1.73	2.2	78	1.3										
	64.8	18	8.4		1.82	2.2	81.5	1.5										
XA65/20	35	9.7	16.4	1450	2.37	3	6	1.8	214	80	65	52						
	55	15.3	15		2.94	4	76.5	2.4										
	66	18.3	13.8		3.2	4	77.5	2.7										
XA65/26	43.2	12	25.3	1450	4.48	5.5	66.5	1.7	264	80	65	81						
	72	20	21.5		5.74	7.5	73.5	2.5										
	86.4	24	18.7		6.47	7.5	68	3.2										
XA65/32	43.2	12	37.4	1450	7.46	11	59	0.7	329	80	65	110						
	72	20	33		9.66	11	67	1.6										
	86.4	24	29		10.5	15	65	2.4										
XA65/32A	37	10.3	34.5	1450	6.32	11	55	1.9	315				80	65	110			
	62	17.2	32		8.31	11	65	2										
	74.5	20.7	28		9.16	11	62	2.3										

## ● Specification

Unit:(mm)

Model	Capacity		Head H (M)	Speed N (R/MIN)	Output		Efficiency (%)	NPSHR (M)	Imp. Dim. (MM)	Inlet/ Outlet Dim.		Weight G(kg)
	M <sup>3</sup> /H	L/S			SHAFT (KW)	MOTOR (KW)				SUCTION	DISCHARGE	
XA65/32B	34	9.4	30.5	1450	6.01	7.5	47	2	300	80	66	110
	56.5	15.7	28		7.3	11	59	2				
	68	18.9	25.8		8.1	11	59	2.1				
XA80/16	50	13.9	10.6	1450	2.31	3	62.5	1.7	174	100	80	54
	80	22.2	10		2.87	3	76	2.1				
	96	26.7	9.3		3.16	3	77	2.4				
XA80/20	63	17.5	15.7	1450	3.59	5.5	75	1.8	214	100	80	70
	105	29.2	14		4.389	7.5	82	2.6				
	126	35	12.8		5.63	7.5	78	3.4				
XA80/26	63	17.5	24	1450	5.88	7.5	70	1.3	264	100	80	91
	105	29.2	21		7.91	11	76	1.9				
	126	35	18.5		8.82	11	72	2.3				
XA80/32	60	16.7	36	1450	9.41	15	62.5	1.9	329	100	80	120
	100	27.8	33		12.66	15	71	2				
	120	33.3	30		14.11	18.5	69.5	2.6				
XA80/32A	57.5	16	34	1450	9.18	11	58	1.9	315	100	80	120
	95.5	26.5	29.7		11.19	15	69	2				
	115	31.8	26		11.92	15	68	2.3				
XA80/32B	54.5	15.1	30.4	1450	8.06	11	56	1.9	300	100	80	120
	91	25.3	27.3		10.1	15	67	2				
	109	30	25		11.24	15	66	2.2				
XA80/40	60	16.7	59	1450	17.37	22	55.5	1.5	409	100	80	161
	100	27.8	55.5		23.08	30	65.5	2.3				
	120	33.3	52.5		25.8	30	66.5	2.5				
XA80/40A	59	16.4	55	1450	16.07	22	55	2.2	395	100	80	161
	96.5	26.8	52.5		21.56	30	64	2.4				
	116	32.2	49		24.57	30	63	3.2				
XA80/40B	56	15.6	51	1450	14.4	22	54	2.2	380	100	80	161
	93	25.8	49		18.8	30	66	2.4				
	112	31	47		20.99	30	68	3				
XA100/20	90	25	15	1450	4.6	7.5	80	1.3	214	125	100	85
	142	39.4	12.7		5.99	7.5	82	1.8				
	170	47.2	10.5		6.52	11	47.5	2				
XA100/26	99	27.5	24	1450	8.51	11	76	1.5	264	125	100	115
	165	45.8	21		11.58	15	81.5	2.3				
	198	55	19		13.66	15	75	2.8				



## ● Specification

Unit:(mm)

Model	Capacity		Head H (M)	Speed N (R/MIN)	Output		Efficiency (%)	NPSHR (M)	Imp. Dim. (MM)	Inlet/ Outlet Dim.		Weight G(kg)						
	M <sup>3</sup> /H	L/S			SHAFT (KW)	MOTOR (KW)				SUCTION	DISCHARGE							
XA100/32	81	22.5	39	1450	11.95	15	72	1.1	329	125	100	134						
	135	37.5	33.7		15.49	22	80	1.6										
	162	45	30		17.3	22	76.5	1.9										
XA100/32A	77.5	21.5	34	1450	10.25	15	70	2	315				125	100	134			
	130	36.1	29.5		13.47	22	76	2										
	155	43.1	26.5		15.32	22	73	2.18										
XA100/32B	73.5	20.4	30	1450	8.96	15	67	2	300							125	100	134
	123	34.2	27		11.9	18.5	76	2										
	148	41	23		13.01	18.5	71	2.1										
XA100/40	90	25	58.8	1450	23.82	30	60.5	0.9	409	125	100	174						
	150	41.7	51		30.86	37	67.5	1.6										
	180	50	44		33.44	45	64.5	2.1										
XA100/40A	87	24.2	54	1450	22.85	30	56	1.7	395				125	100	174			
	145	40.3	48.2		28.84	37	66	2										
	174	48.3	42		29.97	37	66.4	2.5										
XA100/40B	84	23.3	49.5	1450	20.97	30	54	1.7	380							125	100	174
	140	38.8	45.2		26.83	37	64	1.9										
	168	46.5	41.2		29.36	37	64	2.4										
XA125/20	115	31.9	15.2	1450	7.68	11	62	2.6	214	150	125	106						
	190	52.8	13		8.74	11	77	3.5										
	230	63.9	11.5		9.42	11	76.5	3										
XA125/26	144	40	24.2	1450	12.82	18.5	74	1.5	264	150	125	106						
	240	66.7	21.2		17.11	22	81	2.4										
	288	80	17		18.52	22	72	2.8										
XA125/26A	139	38.6	21.3	1450	11.86	15	68	2.3	255				150	125	106			
	232	64.4	18.2		14.56	22	79	2.5										
	279	77.4	15.4		15.57	22	75	3										
XA125/26B	134	37.2	19.7	1450	9.71	15	74	2.3	245							150	125	106
	223	61.9	16		12.79	18.5	76	2.4										
	268	74.3	13.4		14.36	18.5	68	2.8										
XA125/32	120	33.3	35	1450	16.95	22	67.5	1.3	329	150	125	163						
	200	55.6	32.5		22.41	30	79	2										
	240	66.7	30		25.14	30	78	2.6										
XA125/32A	115	31.9	32.8	1450	15.11	18.5	68	2.15	315				150	125	163			
	191	53.1	29.5		19.93	30	77	1.95										
	229	63.3	27.5		22.87	30	75	2.4										

## ● Specification

Unit:(mm)

Model	Capacity		Head H (M)	Speed N (R/MIN)	Output		Efficiency (%)	NPSHR (M)	Imp. Dim. (MM)	Inlet/ Outlet Dim.		Weight G(kg)
	M <sup>3</sup> /H	L/S			SHAFT (KW)	MOTOR (KW)				SUCTION	DISCHARGE	
XA125/32B	109	30.3	28.9	1450	11.83	18.5	72.5	2.2	300	150	125	163
	182	50.6	25.2		16.43	22	76	2				
	219	60.7	12.9		10.37	22	74	2.2				
XA125/40	144	40	59.5	1450	30.3	45	77	1.3	409	150	125	101
	245	68.1	52		45.35	55	76.5	2.1				
	300	83.3	45		52.15	75	70.5	2.8				
XA125/40A	139	38.6	53.5	1450	31.4	37	64.5	2.2	395	150	125	181
	237	64.7	46		40.04	55	74	2.4				
	289	80.3	38.5		45.23	55	67	3				
XA125/40B	134	37.1	51.2	1450	29.08	37	64	2.2	380	150	125	181
	228	63.2	40		35.15	45	70.5	2.3				
	279	77.4	32.5		40.41	55	61	2.8				
XA125/50	150	41.7	83.5	1450	54.14	75	63	2.3	500	150	125	390
	250	69.4	78		75.86	90	70	2.5				
	300	83.3	72		90.5	110	65	2.6				
XA125/50A	135	37.5	78.5	1450	48.1	55	60	1.8	485	150	125	390
	225	62.5	75		62.1	75	74	2.1				
	270	75	71		68.69	75	76	2.5				
XA125/50B	120	33.3	75	1450	45.39	55	54	1.6	470	150	125	390
	200	55.6	72		58.53	75	67	2				
	240	66.7	69		64.43	75	70	2.4				
XA125/50C	90	25	67	1450	32.84	37	50	1.6	445	150	125	390
	150	41.7	65.5		41.81	45	64	2				
	180	50	62		45.36	55	67	2.4				
XA150/20	216	60	14.4	1450	12.1	18.5	70	3	220	200	150	156
	360	100	12.2		14.95	18.5	80	3.5				
	425	118	10.3		15.47	18.5	77	4				
XA150/20A	173	48	13.4	1450	9.27	15	68	2.8	0	200	150	156
	288	80	12		12.07	15	78	3.3				
	346	96	10.5		13	15	76	3.8				
XA150/26	194	53.9	23.5	1450	16.55	22	75	2.7	264	200	150	148
	324	90	20.5		22.06	30	82	3				
	414	115	16		26.53	30	68	3.3				
XA150/26A	180	50	21.2	1450	14.43	18.5	72	2.5	255	200	150	148
	300	83.3	19		19.53	30	79.5	2.8				
	389	108	14.5		22.58	30	68	3.1				



## ● Specification

Unit:(mm)

Model	Capacity		Head H (M)	Speed N (R/MIN)	Output		Efficiency (%)	NPSHR (M)	Imp. Dim. (MM)	Inlet/ Outlet Dim.		Weight G(kg)						
	M <sup>3</sup> /H	L/S			SHAFT (KW)	MOTOR (KW)				SUCTION	DISCHARGE							
XA150/26B	162	45	19	1450	11.33	15	74	2.3	240	200	150	148						
	270	75	16.5		15.36	22	79	2.6										
	342	95	12.5		17.12	22	68	3										
XA150/32	230	63.9	36.5	1450	30.89	37	74	2.3	329	200	150	170						
	370	103	33		41.05	45	81	2.8										
	445	124	28.5		46.05	55	75	3.2										
XA150/32A	220	61.1	33.4	1450	27.79	37	72	2.8	315				200	150	170			
	354	98.3	29.3		35.76	45	79	3.1										
	426	118	25		39.19	45	74	3.5										
XA150/32B	210	58.2	30	1450	24.11	30	71	2.8	300							200	150	170
	338	93.8	26		31.04	37	77	3										
	406	113	21.9		33.13	37	73	3.3										
XA150/40	240	66.7	58	1450	50.54	75	75	2.4	409	200	150	209						
	385	107	53.5		66.78	75	84	3										
	460	128	49		73.96	90	83	3.6										
XA150/40A	232	64.4	52	1450	45.63	55	72	2.8	395				200	150	209			
	372	103	47.5		61.69	75	78	3.2										
	444	123	42.5		66.74	75	77	3.6										
XA150/40B	223	61.9	48	1450	41.64	55	70	2.8	380							200	150	209
	358	99.3	43.5		55.72	75	76	3.1										
	428	119	39		61.36	75	74	3.5										
XA150/50	300	83.3	86.5	1450	89.5	132	79	3.1	500	200	150	410						
	500	139	77.5		125.6	160	84	3.5										
	600	167	69		139.2	160	81	3.8										
XA150/50A	270	75	79.5	1450	79	110	74	3	485	200	150	410						
	450	125	72		110.3	132	80	3.4										
	540	150	63		120.3	132	77	3.6										
XA150/50B	240	66.7	75.5	1450	71.5	90	69	2.8	470				200	150	410			
	400	111	70		96.5	110	79	3.2										
	480	133	65		108.9	132	78	3.5										
XA150/50C	210	58.3	68	1450	58	75	67	2.6	445							200	150	410
	350	97.2	63		78	90	77	3										
	420	117	60.5		91.1	110	76	3.3										
XA200/26	259	72	19.5	1450	18.86	22	73	3	264	200	150	256						
	432	120	15.2		21.81	30	82	3.2										
	518	144	12		22.89	30	74	3.3										

## ● Specification

Unit:(mm)

Model	Capacity		Head H (M)	Speed N (R/MIN)	Output		Efficiency (%)	NPSHR (M)	Imp. Dim. (MM)	Inlet/ Outlet Dim.		Weight G(kg)
	M <sup>3</sup> /H	L/S			SHAFT (KW)	MOTOR (KW)				SUCTION	DISCHARGE	
XA250/32A	480	133	29.5	1450	61.21	75	63	2.8	318	300	250	375
	800	222	25.5		67.75	75	82	4.5				
	960	267	22.5		70.45	90	83.5	6.2				
XA250/32B	450	125	28	1450	55.34	75	62	2.5	310	300	250	375
	750	208	24.5		61.78	75	81	4.5				
	900	250	22		65.76	75	82	6				
XA250/32C	432	120	23.5	1450	45.32	55	61	2.4	300*288	300	250	375
	720	200	20		49.02	55	80	4				
	864	240	17.5		54.18	75	76	5.8				
XA250/40	550	153	56.5	1450	112.1	132	75.5	3	422	300	250	455
	760	211	54		131.5	160	85	3.5				
	950	264	48.5		151.2	200	83	4.5				
XA250/40A	360	100	45	1450	71.16	90	62	2.6	380	300	250	455
	600	167	43		87.83	110	80	3.2				
	720	200	40.5		95.68	110	83	4.2				
XA250/40B	300	83.3	35	1450	51.52	75	55.5	2.3	338	300	250	455
	500	139	33		59.91	75	75	3				
	600	167	31		64.12	75	79	4				
XA250/50	534	148	85.5	1450	177.6	250	70	3	500	300	250	630
	890	247	80		236.5	280	82	5				
	1068	297	74		265.7	315	81	7				
XA250/50A	480	133	76	1450	148.3	200	67	2.8	475	300	250	630
	800	222	70.5		192	250	80	4.6				
	690	267	65.5		214.1	250	80	6.7				
XA250/50B	450	125	68	1450	128.2	160	65	2.6	450	300	250	630
	750	208	63		163.9	200	78.5	4.4				
	900	250	58.4		181.2	200	79	6.5				
XA300/40	832	231	52	1450	168.2	200	70	5	415	300	300	700
	1386	385	46.5		204.1	200	86	7				
	1663	462	42		217.4	250	87.5	8				
XA300/40A	720	200	45	1450	135.8	160	65	4.8	385	300	300	700
	1200	333	40.5		163.4	200	81	6.5				
	1440	400	37		177	200	82	7.5				
XA300/40B	594	165	38.5	1450	114.3	132	54.5	4.5	360*6°	300	300	700
	990	275	35		127.5	160	74	6				
	1188	330	32.5		133.1	160	79	7				



## ● Specification

Unit:(mm)

Model	Capacity		Head H (M)	Speed N (R/MIN)	Output		Efficiency (%)	NPSHR (M)	Imp. Dim. (MM)	Inlet/ Outlet Dim.		Weight G(kg)									
	M <sup>3</sup> /H	L/S			SHAFT (KW)	MOTOR (KW)				SUCTION	DISCHARGE										
XA200/26A	248	69	18	1450	16.91	22	72	2.9	255	200	150	256									
	414	115	14		19.49	22	81	3.1													
	497	138	10.5		19.73	22	72	3.2													
XA200/26B	238	66	15	1450	13.87	18.5	70	2.8	245				200	150	256						
	396	110	12		16.18	18.5	80	3													
	475	132	9.7		17.93	18.5	70	3.1													
XA200/32	345	95.8	35	1450	45.36	55	72.5	3.2	340	250	200	310									
	575	160	30		56.26	75	83.5	3.3													
	690	192	25.5		60.27	75	79.5	3.4													
XA200/32A	324	90	30	1450	37.28	45	71	3.1	320				250	200	310						
	540	150	25.5		45.18	55	83	3.2													
	648	180	21		47.51	55	78	3.3													
XA200/32B	302	84	26.5	1450	32.33	45	67.5	3	300							250	200	310			
	504	140	22		36.82	45	82	3.1													
	605	168	18.3		38.89	45	77.5	3.2													
XA200/40	390	108	59.5	1450	85.4	110	74	3	418										250	200	345
	650	181	53.5		112.7	132	84	3.8													
	780	217	48.5		125.6	132	82	4.5													
XA200/40A	360	100	52.5	1450	73.53	90	70	2.9	400	250	200	345									
	600	167	46.5		93.8	110	81	3.6													
	720	200	41.5		101.7	110	80	4.4													
XA200/40B	330	91.7	41.5	1450	54.05	75	69	2.8	370				250	200	345						
	550	153	36		66.57	90	81	3.5													
	660	183	31		71.43	90	78	4.2													
XA200/50	330	91.7	90	1450	118.9	132	68	3.2	500							250	200	510			
	550	153	87		160.9	200	81	4													
	660	183	84.5		189.9	250	80	4.8													
XA200/50A	300	83.3	82.5	1450	97.68	110	69	3	480										250	200	510
	500	139	80		132	160	82.5	3.8													
	600	167	77.5		150.8	200	84	4.5													
XA200/50B	270	75	73	1450	85.2	110	63	2.8	460	250	200	510									
	450	125	71.5		112.3	132	78	3.6													
	540	150	69		126.8	160	80	4.2													
XA250/32	522	145	32	1450	65.93	75	69	3	328				300	250	375						
	870	242	27.5		78.03	90	83.5	4.8													
	1044	290	24		83.21	90	82	6.5													