



**EST.1969**

*Professional Water Pump Manufacturer in Taiwan*

# CATALOG

**60HZ**

## **IL-SERIES** *Vertical In-line Centrifugal Pump*



**ASIA AUTOMATIC PUMP CO.,LTD**



<http://www.evergushpump.com.tw>

## Features

**60HZ**

- Vertical and compact design for saving installation space.
- The motor and pump are coaxial conjoined for eliminating fluctuation and reducing maintenance costs.
- Adopting durable Mechanical seal to prevent from leakage and to keep long life.
- Special volute design for low noise operation and great performance.

## Applications

- Water circulation for cooling systems, chiller, cooling tower,...,etc.
- Water supply for facilities, equipment of factories.
- For booster pump system and irrigation system.
- Water lifting for the top reservoirs of buildings, public facilities, hotels, apartments,...,etc.

## Installation

- Water circulation for Cooling System, chiller, cooling tower...,etc.

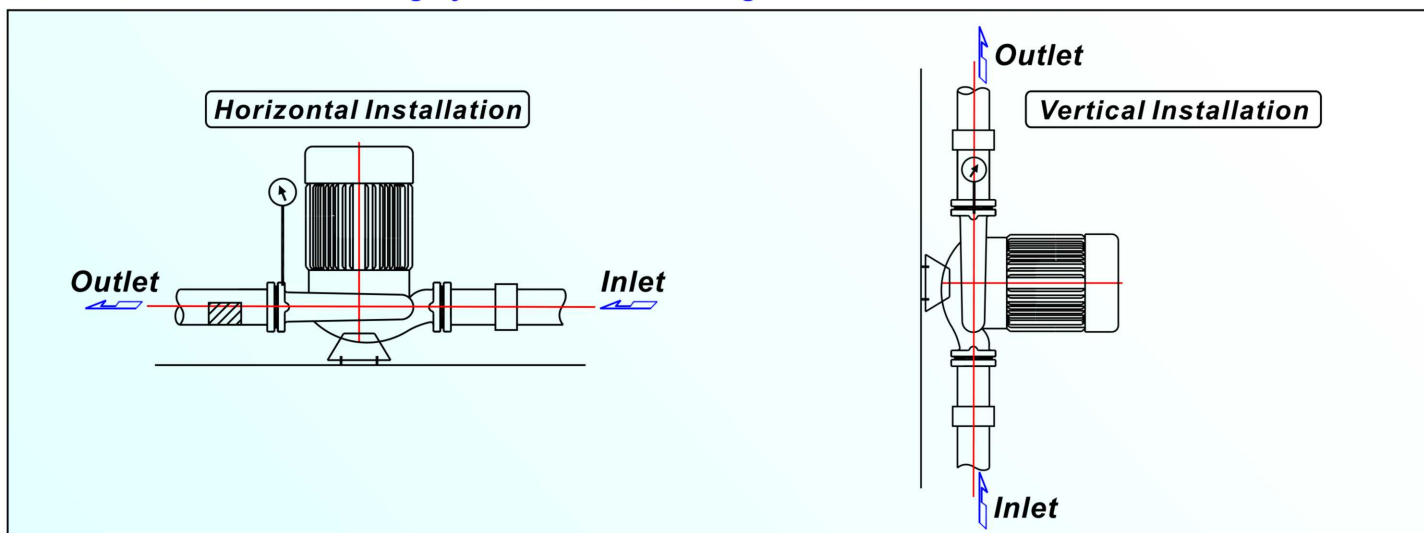

- Water Supply for buildings, factories, public facilities...,etc.

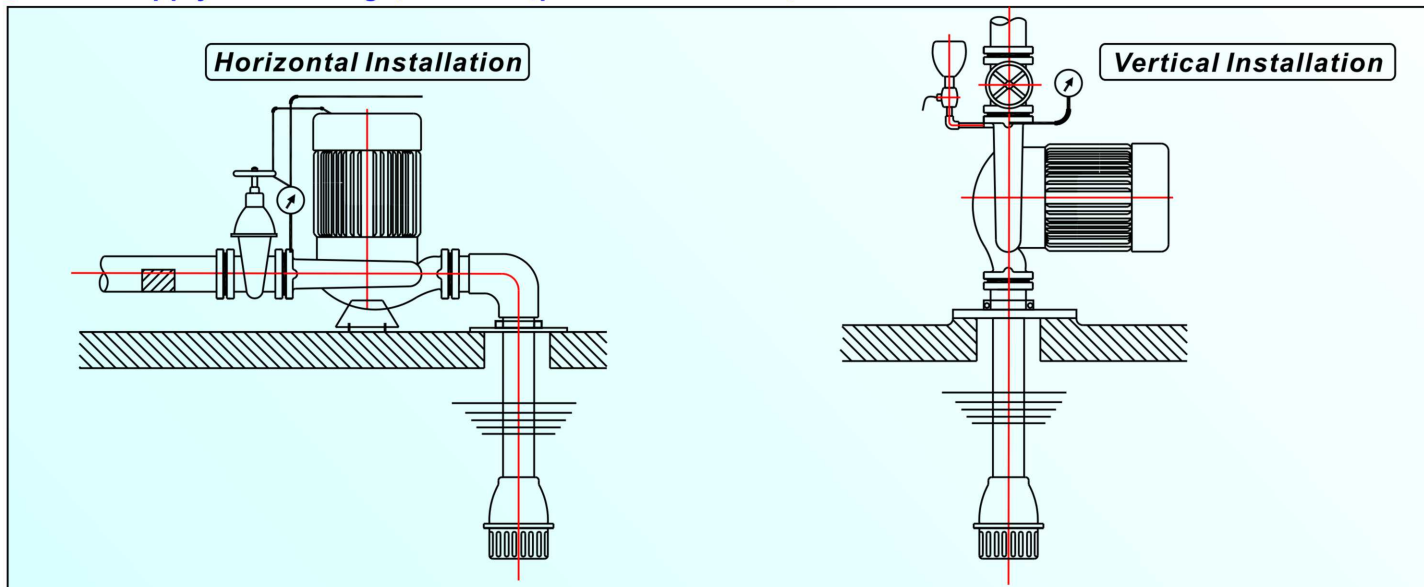

## Performance Table

60HZ

2P ; 3500rpm ; 3 Phase motor ; H(M) ; Q(L/min)																	
Model	HP	In/Out	5M	10M	15M	20M	25M	30M	35M	40M	45M	50M	55M	60M	65M	70M	80M
IL25-2.4	½	1"x1"	90														
IL40-2.75	1	1½"x1½"	250	200	100												
IL50-21.5	2	2"x2"	400	350	280												
IL50-22.2	3	2"x2"	520	480	400	240											
IL65-22.2	3	2½"x2½"	670	600	400	190											
IL50-23.7	5	2"x2"	450	430	370	360	330	220									
IL80-23.7	5	3"x3"	650	600	550	500	300										
IL50-25.5	7.5	2"x2"		430		390		360	330	230	85						
IL80-25.5	7.5	3"x3"	700	690	670	650	630	470	250								
IL100-25.5	7.5	4"x4"	1310	1000	670	280											
IL50-27.5	10	2"x2"		470		440		370		320	280	250	200				
IL80-27.5	10	3"x3"	920	870	790	700	650	560	420	300							
IL100-27.5	10	4"x4"	1560	1310	1070	820	470										
IL80-211	15	3"x3"	1050	1010	1000	990	970	950	870	740	700	560	480	250			
IL100-211	15	4"x4"	1760	1680	1590	1360	1050	580	160								
IL80-215	20	3"x3"		1200		1160		1150		1120		1010		670			
IL100-215	20	4"x4"	2050	2010	1960	1810	1450	1000									

2P ; 3500rpm ; 1 Phase motor ; H(M) ; Q(L/min)																	
Model	HP	In/Out	5M	10M	15M	20M	25M	30M	35M	40M	45M	50M	55M	60M	65M	70M	80M
IL25-2.4A	½	1"x1"	90														
IL40-2.75A	1	1½"x1½"	250	200	100												
IL50-21.5A	2	2"x2"	400	350	280												
IL65-22.2A	3	2½"x2½"	670	600	400	190											

4P ; 1750rpm ; 3 Phase motor ; H(M) ; Q(L/min)									
Model	HP	In/Out	10 M	15 M	20 M	25 M	30 M	35 M	40 M
IL100-411	15	4"x4"	1710	1610	1420	1250	910		
IL150-411	15	6"x6"	2600	2490	1980	450			
IL100-415	20	4"x4"	1830	1810	1780	1730	1520	1160	650
IL150-415	20	6"x6"	2600	2550	2490	2300			
IL150-418	25	6"x6"	4110	3950	3750	2980	1520		
IL200-422	30	8"x8"	5400	4900	4100	2900			
IL200-430	40	8"x8"		5400	4840	4050	3000		

## Dimensions

60HZ

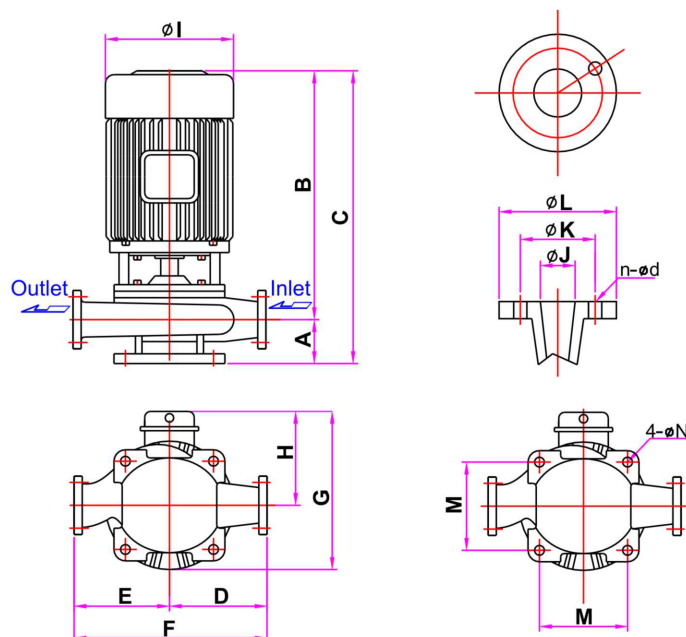

### 2P model detailed dimensions

Model	HP	In/Out	A	B	C	D	E	F	G	H	I	J	K	L	M	N	n	d
IL25-2.4	1/2	1"x1"	75	290	365	142	142	284	165	83	162	25	90	125	108	17	4	19
IL40-2.75	1	1½"x1½"	118	312	430	150	150	300	192	89	117	40	105	140	146	18	4	19
IL50-21.5	2	2"x2"	93	367	460	155	155	310	210	105	200	50	120	155	146	18	4	19
IL50-22.2	3	2"x2"	114	364	478	176	176	352	225	113	200	65	140	175	180	18	4	19
IL65-22.2	3	2½"x2½"	133	422	555	186	186	372	250	125	238	80	150	185	180	18	8	19
IL50-23.7	5	2"x2"	133	422	555	186	186	372	275	125	238	80	150	185	180	18	8	19
IL80-23.7	5	3"x3"	133	462	595	186	186	372	275	138	275	80	150	185	180	18	8	19
IL50-25.5	7.5	2"x2"	126	486	612	215	215	430	280	140	275	80	150	185	195	18	8	19
IL80-25.5	7.5	3"x3"	143	475	618	194	194	388	275	138	275	100	175	210	195	18	8	19
IL100-25.5	7.5	4"x4"	126	486	612	215	215	430	280	140	275	80	150	185	195	18	8	19
IL50-27.5	10	2"x2"	143	493	636	194	194	388	275	138	275	100	175	210	195	18	8	19
IL80-27.5	10	3"x3"	126	609	735	215	215	430	334	167	334	80	150	185	195	18	8	19
IL100-27.5	10	4"x4"	143	617	760	194	194	388	334	167	334	100	175	210	195	18	8	19
IL80-211	15	3"x3"	145	595	740	195	195	390	390	224	334	150	240	280	195	18	8	19
IL100-211	15	4"x4"	126	609	735	215	215	430	334	167	334	80	150	185	195	18	8	19
IL80-215	20	3"x3"	143	617	760	194	194	388	334	167	334	100	175	210	195	18	8	19
IL100-215	20	4"x4"	145	595	740	195	195	390	390	224	334	150	240	280	195	18	8	19

### 4P model detailed dimensions

Model	HP	In/Out	A	B	C	D	E	F	G	H	I	J	K	L	M	N	n	d
IL100-411	15	4"x4"	165	651	816	318	318	635	500	250	334	100	175	210	160	22	8	19
IL150-411	15	6"x6"	210	616	826	380	350	730	500	250	334	150	240	280	270	23	8	23
IL100-415	20	4"x4"	165	651	816	318	318	635	500	250	334	100	175	210	160	22	8	19
IL150-415	20	6"x6"	210	660	870	380	350	730	500	250	334	150	240	280	270	23	8	23
IL150-418	25	6"x6"	210	760	970	380	350	730	500	250	385	150	240	280	270	23	8	23
IL200-422	30	8"x8"	210	760	970	380	355	735	500	250	385	200	290	330	270	23	12	23
IL200-430	40	8"x8"	210	890	1031	380	355	735	500	250	420	200	290	330	270	23	12	23

The technical data are subject to amend without notice.